

Bulb + Socket 001544/2594 for Speed + Fuel

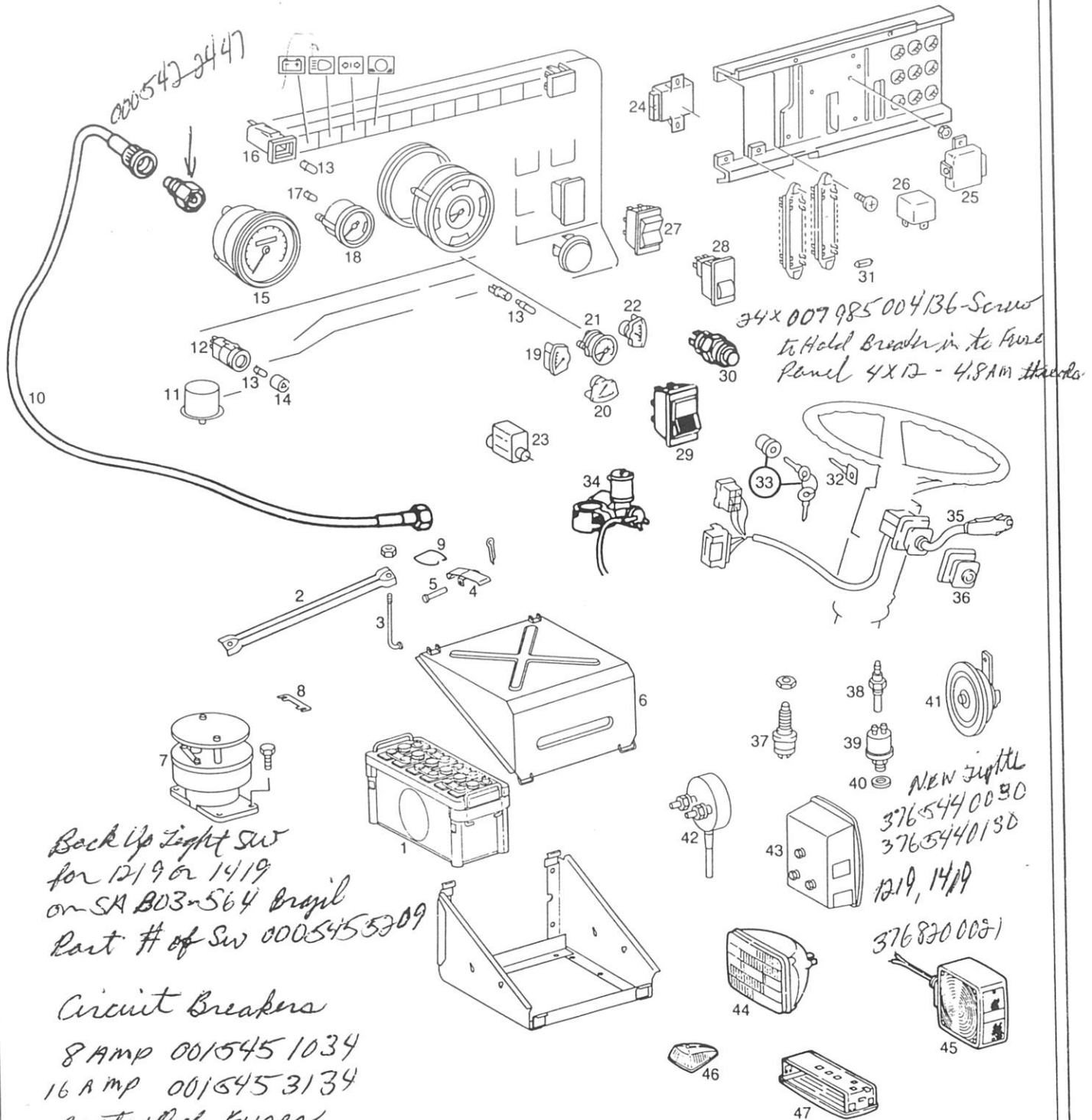

REF. NO.	PART NUMBER	DESCRIPTION	QTY.						
				LPS1525					
1	376 541 00 01	Battery	2	■					
2	345 541 71 13	Hold Down	2	■					
3	345 541 71 22	Hook, Hold Down	4	■					
4	344 540 00 19	Mounting Latch	2	■					
5	001434 005029	Pin	2	■					
6	376 540 00 82	Cover	1	■					
7	000 545 42 08	Switch, Series Parallel	1	■					
8	345 545 76 34	Fuse For Series Parallel Switch	1	■					
9	344 541 00 26	Spring Bracket	2	■					
10	005 542 02 07	Speedometer Cable	1	■					
11	900 544 01 32	Sender Unit	1	■					
12	004 545 02 24	Switch, Hazard Warning	1	■					
13	072601 012800	Bulb, 12V/2W	1	■					
14	000 545 35 37	Button	1	■					
15	008 542 21 06	Speedometer	1	■					
16	344 545 71 15	Tell-Tale Lamp Housing	1	■					
17	072601 012230	Bulb, 12V/1.2W	2	■					
18	002 542 80 16	Tachometer	1	■					
19	002 542 26 02	Gauge, Oil Pressure	1	■					
20	002 542 91 03	Gauge, Fuel	1	■					
21	001 542 06 08	Gauge, Air Pressure	1	■					
22	003 542 87 05	Gauge, Temperature	1	■					
23	387 542 09 09	Adapter, Speedometer on Transmission	1	■					
24	002 545 95 32	Switch, Kick Down	1	■					
25	005 545 13 24	Sender Unit, Wiper	1	■					
26	000 545 97 05	Relay	3	■					

LPS/Chassis

Electrical/Group 54

REF. NO.	PART NUMBER	DESCRIPTION	QTY.	LPS1525					
27	376 545 72 14	Switch, Head Light <i>345 545 71/28 Plug.</i>	1	■					
28	364 542 73 25	Switch, Instrument Lighting	1	■					
29	376 545 00 14	Switch, Blinker Light and Marker Light	1	■					
30	345 545 71 14	Switch, Starter	1	■					
31	308 545 02 34	Fuse, 8 Amp	16	■					
31	000 545 83 34	Fuse, 16 Amp	3	■					
32	000 766 37 06	Key, Blank	AR	■					
33	381 760 00 05	Tumbler Key Kit	1	■					
34	001 462 19 30	Steering Lock Switch	1	■					
35	005 545 51 24	Switch, Turn Signal, Horn, Etc.	1	■					
36	608 545 00 45	Boot	1	■					
37	000 545 69 09	Switch, Stop Light	1	■					
38	004 542 56 17	Sender Unit, Temperature	1	■					
39	002 542 17 17	Sender Unit, Oil Temperature	1	■					
40	007603 014405	Seal	1	■					
41	344 542 77 20	Horn	1	■					
42	376 544 00 30	Lamp, Blinker Rear	2	■					
43	344 544 73 03	Lamp, Tail Left	1	■					
43	344 544 74 03	Lamp, Tail Right	1	■					
44	000 826 62 99	Sealed Beam, High Beam	2	■					
44	000 826 63 99	Sealed Beam, Low Beam	2	■					
45	376 822 70 20	Front, Left and Right Blinker Lamp	2	■					
46	331 826 71 47	Lamp, Roof Marker <i>Dark Amber almost</i>	5	■					
47	000 820 77 01	Lamp, Dome	1	■					

Buying genuine Mercedes-Benz parts gives you full warranty coverage at any of our over 200 dealers nationwide. Don't be fooled—there is a difference. Demand genuine Mercedes-Benz truck parts!

376 826 70 47 - Lamp. Not Road

000 826 1710 - Lens " " "

Antenna box 376.7