

REF. NO.	PART NUMBER	DESCRIPTION	QTY.	OM429LA											
				953											
1	429 030 00 37	Piston with Liner Kit	5	■											
2	423 030 01 24	Piston Ring Parts Kit	5	■											
3	423 037 02 16	Piston Ring, Groove One	5	■											
4	423 037 01 17	Piston Ring, Groove Two	5	■											
5	423 037 01 18	Piston Ring, Groove Three	5	■											
6	407 038 12 10	Connecting Rod Bearing Shell	5	■											
7	407 030 06 40	Main Bearing Kit, Standard 104.00mm	5	■											
8	407 030 06 45	Thrust Bearing Parts Kit, Standard 104.00mm x 45.81mm	1	■											
9	004 981 21 25	Clutch Pilot Bearing	1	■											
10	403 032 03 09	Flywheel Intermediate Ring	1	■											
11	403 032 03 05	Flywheel Ring Gear	1	■											

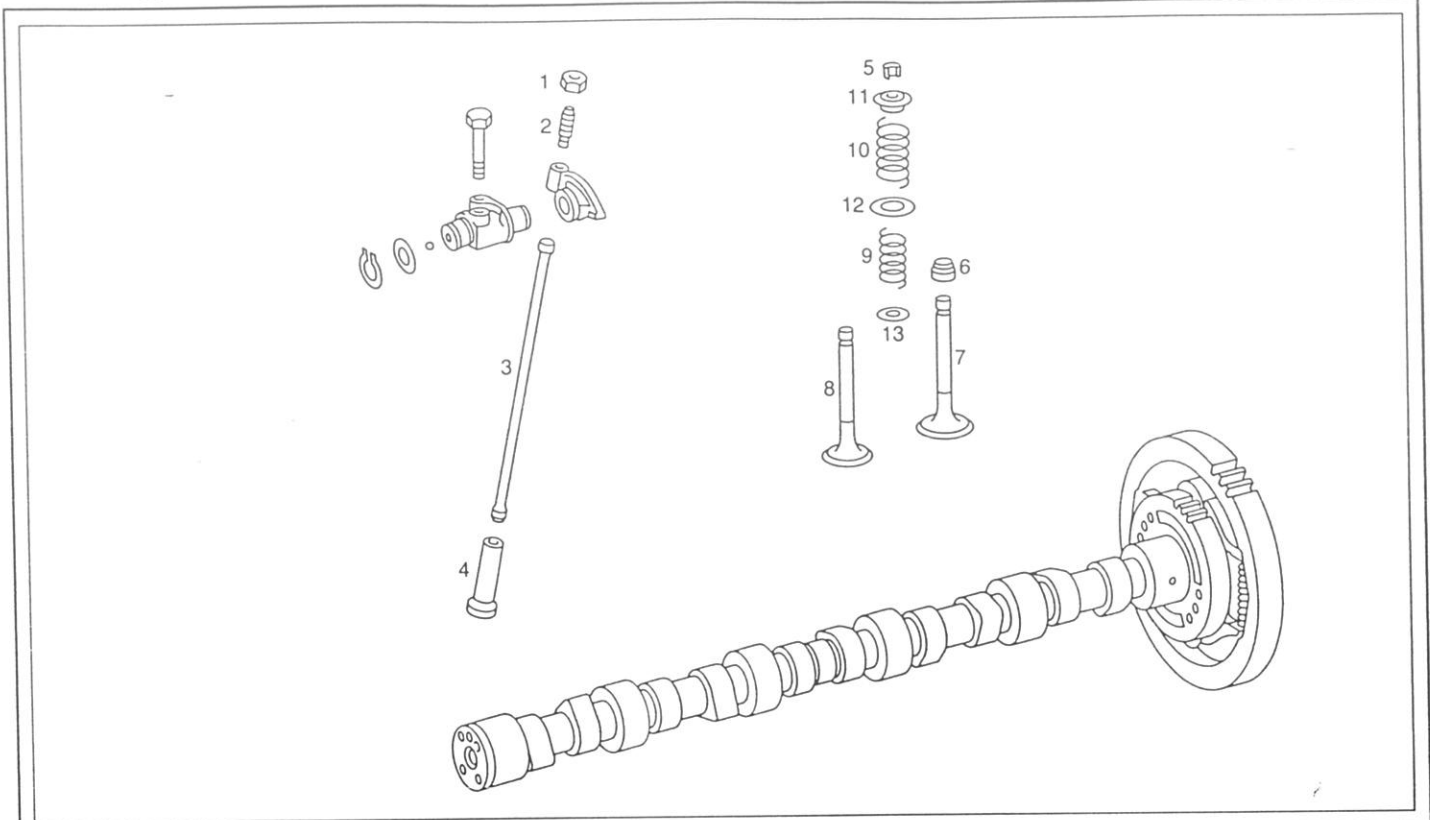

REF. NO.	PART NUMBER	DESCRIPTION	QTY.	OM429LA														
				953														
1	312 990 02 51	Nut	10	■														
2	403 055 02 20	Set Screw	10	■														
3	407 054 04 05	Push Rod	10	■														
4	403 054 18 01	Valve Tappet, Standard 20.00mm	10	■														
5	422 053 00 26	Valve Keepers	20	■														
6	403 053 01 96	Valve Stem Seal, Intake and Exhaust	10	■														
7	422 050 02 27	Exhaust Valve	5	■														
8	422 050 00 26	Intake Valve	5	■														
9	403 053 06 22	Inner Valve Spring	10	■														
10	403 053 01 20	Outer Valve Spring	10	■														
11	422 053 00 25	Spring Retainer	10	■														
12	403 053 01 52	Outer Spacer Washer	10	■														
13	403 053 00 52	Inner Spacer Washer	10	■														

Use of counterfeit or will-fit parts, or any parts not supplied by Mercedes-Benz Truck Company, may void your truck warranty, so use only genuine Mercedes-Benz replacement parts.